

Birdzoff BirdSpring Installation Guide

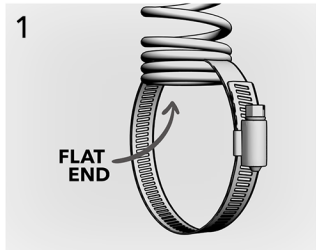

1 Locate the flat end of spring and insert clamp band between the 2nd and 3rd coils. Note: you can open the clamp first and then insert the band between coils.

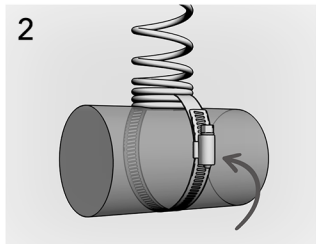

2 Install spring/clamp.

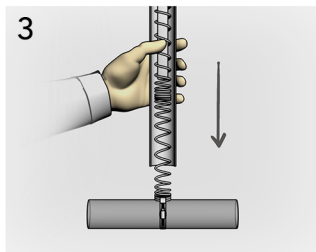

3 Place Wire Centering Tool over spring and slide down.

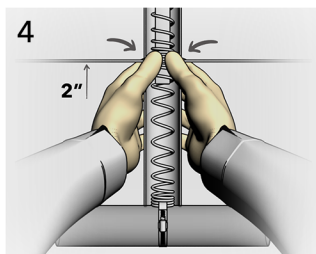

4 Place first wire between two coils at the middle level, leaving two inches of wire at the end of the spring. Keep thumbs close together on wire against coils and push the wire between two coils. Cut off the wire on the left at the 2" mark

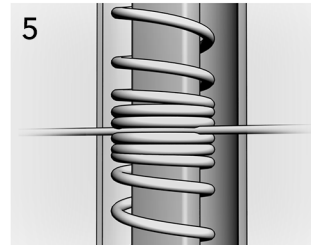

5 Push wire into the coils until they make contact with the Wire Centering Tool.

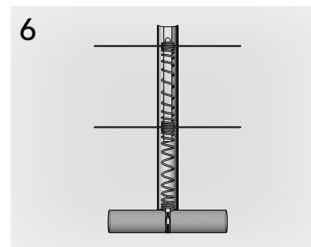

6 Repeat steps 4-5 to install the second wire in the upper level of spring coils.

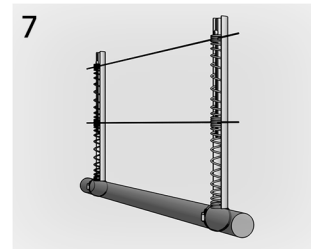

7 Install next spring at a maximum of 5' distance and repeat steps 3-6. Use the inserted wires from the first spring to complete the connection to the second spring.

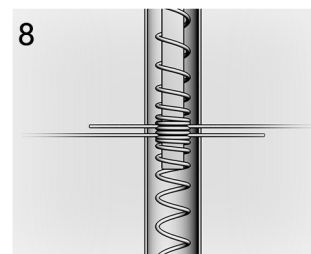

8 Add the next set of wires in the middle level coils and then the upper level coils. When installing a second wire into a set of coils, insert the second wire between different coils from the first wire.

Birdzoff BirdSpring Installation Guide

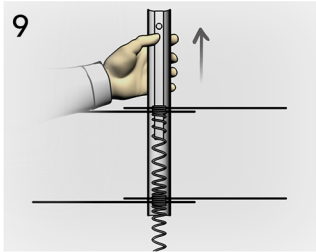

9 Once wires are installed in spring, remove the Wire Centering Tool. Adjust wires to center if necessary.

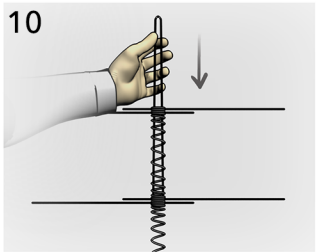

10 Squeeze clip and insert clip ends inside spring circumference and outside lateral wires to capture them. Slide all the way down.

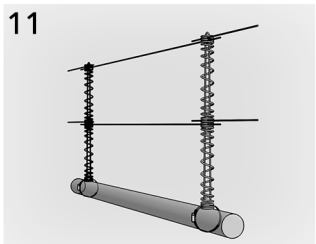

11 Completed view of an In Line spring system.

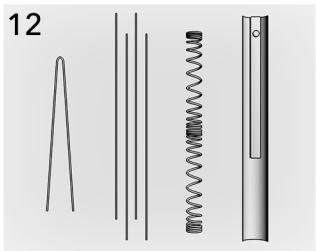

12 Parts: Capture clip, wires, spring
Tool: Wire Centering Tool

BirdSpring Parts

Parts	Units	Springs	Clips	Connecting Wires	Price
BS10HC	10	10	10	20	\$450
BS25HC	25	25	25	50	\$1125
BS50HC	50	50	50	100	\$2250
BSKIT	1	-	-	-	\$100

BirdSpring Attachments

Parts	Attachment
BS10HC	Hose Clamp
BS10FB	Flat Base
BS25M	Magnet

Call for Pricing and Delivery Options
To make an order, call 866-247-3963